

# RIVER BEND

UINTAH County of Utah

Effective Date: 3/21/1977

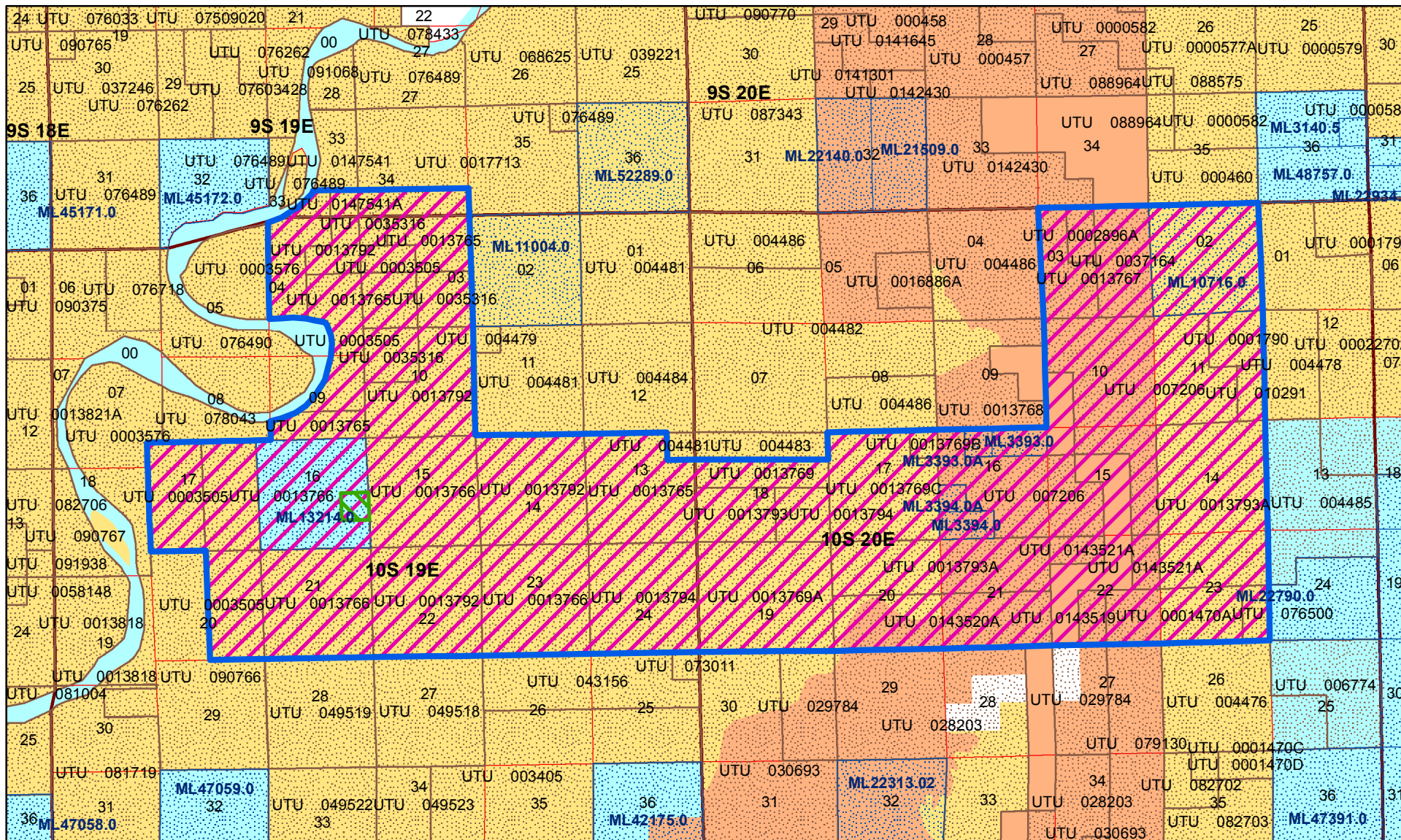

- PA= Formation Name**
- PA= Wasatch-Mesaverde "A-B" PA  
UTU 063054A
  - PA= Green River B  
UTU 063054C
  - Oil and Gas Unit Agreement

- Oil and Gas Lease Parcels**
- Authorized Oil and Gas Lease Parcels
  - Pending Oil and Gas Lease Parcels
  - SITLA Oil and Gas Lease Parcels

**UTU 063054X**  
Acres: 2320.0

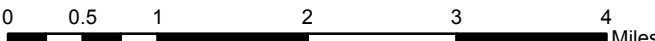

- Bureau of Land Management (BLM)
- US Forest Service (USFS)
- National Park Service (NPS)
- Indian Reservation (IR)
- State
- Private
- Township
- Section

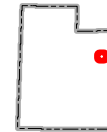

Date: 1/17/2018